

The Gardens of the Villa Lante, Bagnaia, Italy



Gardens of the Villa Lante - Top View & Side View Schematic



Top View



Side View

Down the Mountain



The Villa Lante is set up into 3 main levels that controlled the flow of water from the mountainside down to the town below.

The Grotto and Upper Level

The Grotto sits at the summit of the hill from which all the waters flows down towards the Town. This area includes the Fountain of the Dolphins as well as terraced straight water path to the Fountain of the Giants

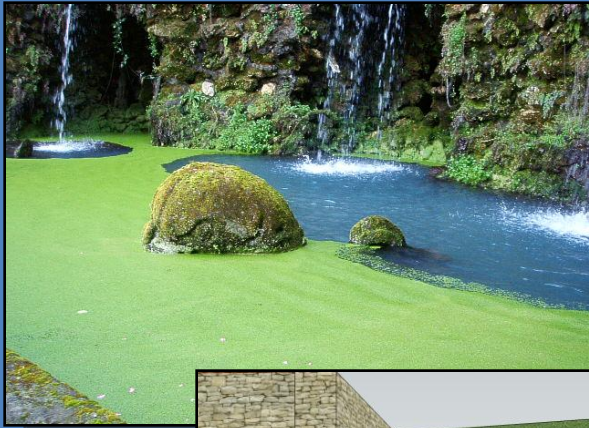

The Cardinal's Table and Casini Level

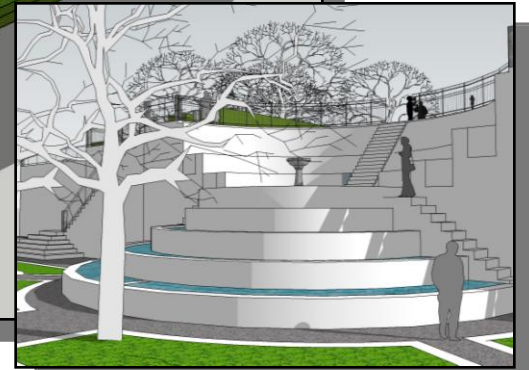
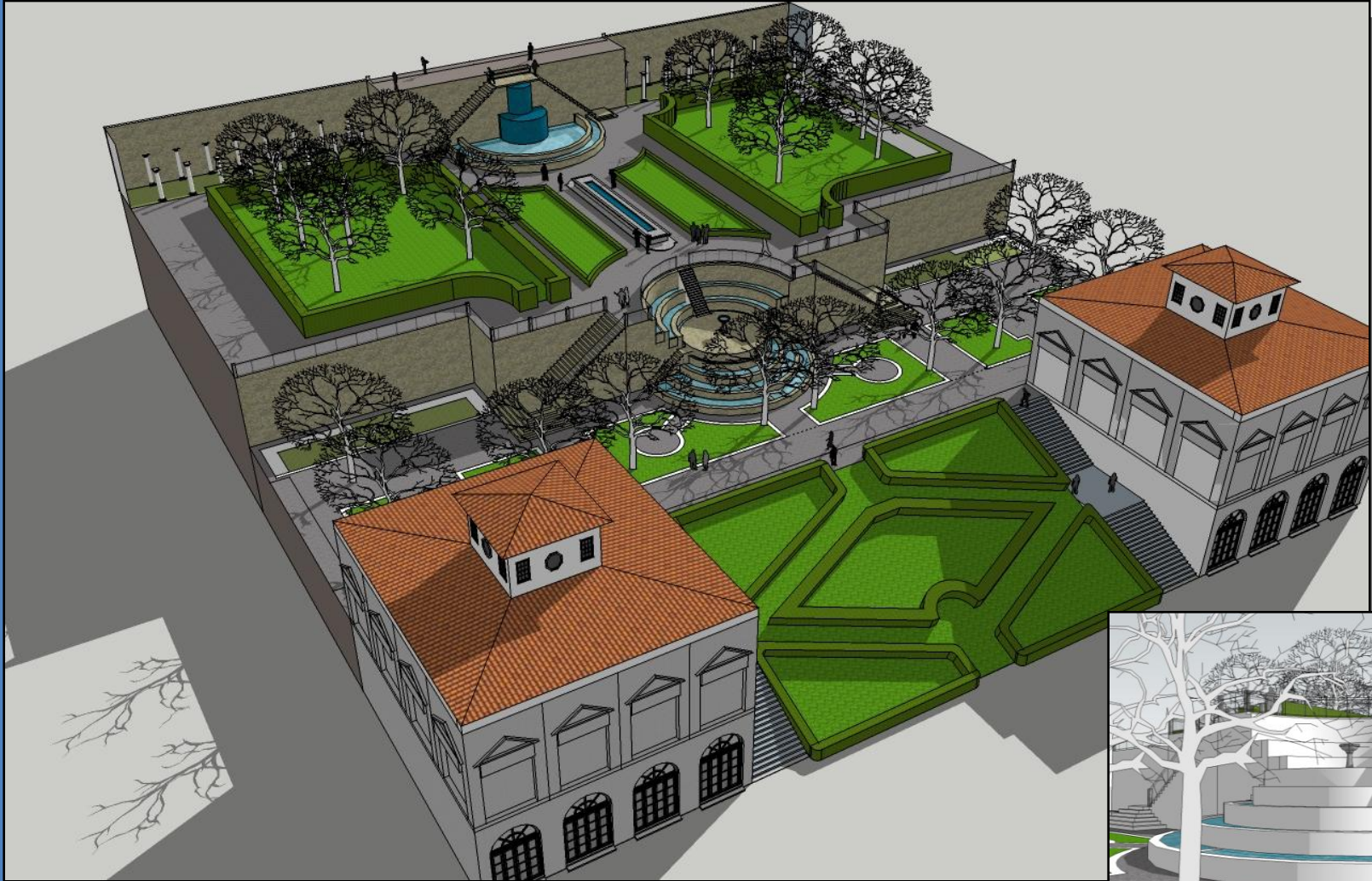

Past the Fountain of the Giants is the Cardinal's Table which features a center channel, which in fact was used to chill bottles of wine. And below that are the two Casini which were built as the Cardinal's dwellings.

The Cardinal's Table and Casini Level

The Two Casini were built separate from each other with about 30 years in-between, but are exact duplicates of each other. They form a visual barrier between the Gardens and the upper levels.

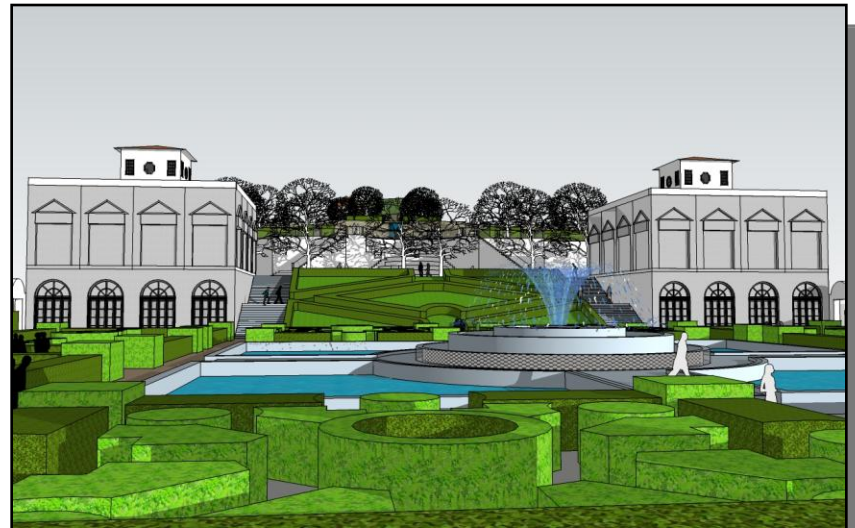
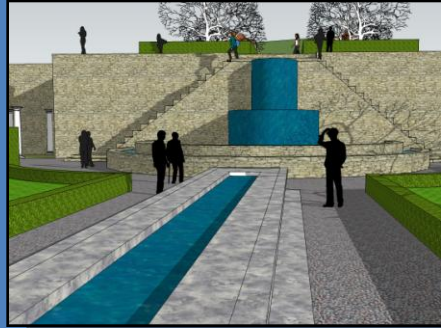

The Lower Gardens

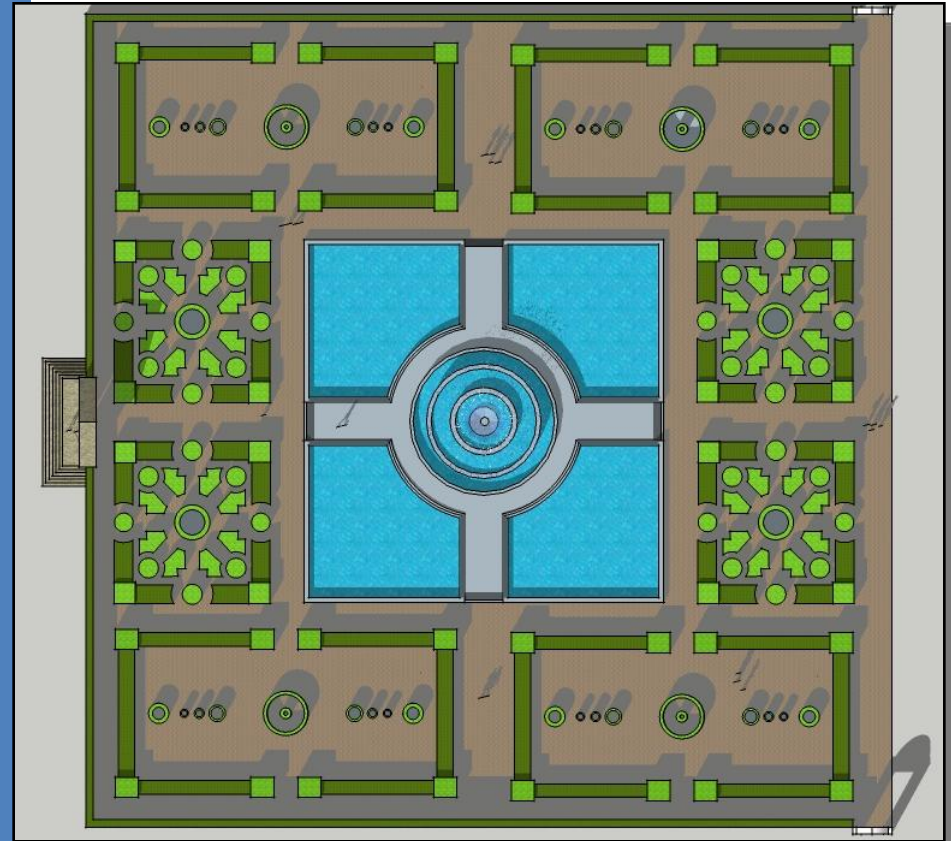

The Gardens at the bottom of the Villa Lante stand as a testament to geometric landscaping and provide an entryway from the town below.

