

# Final Portfolio

## Joel Webne

INTRO TO SKETCHUP URB PLNR URSP-691-901-2011

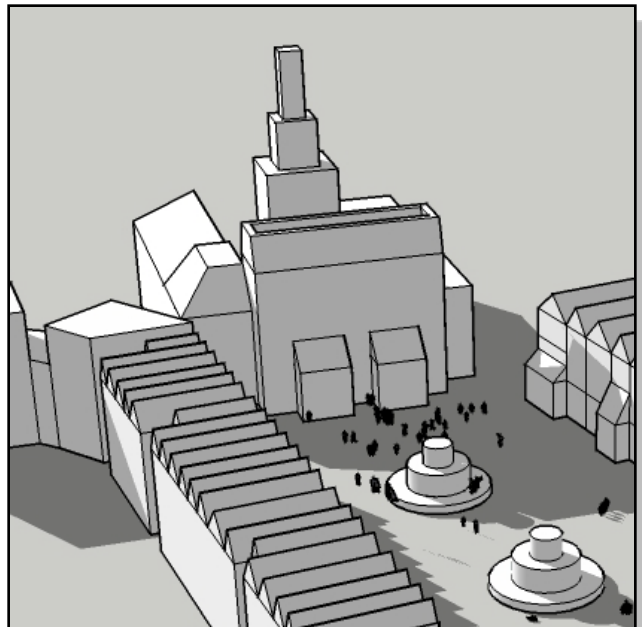
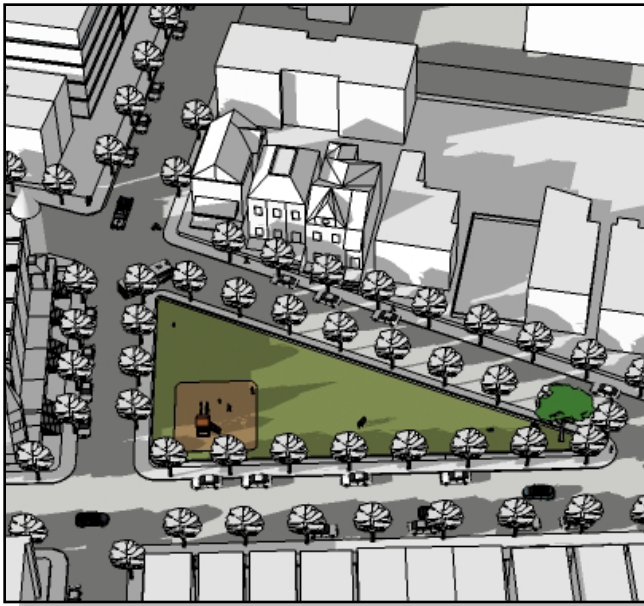

# Abner Clay Park – Prospective Park/Urban Design Schematic – Current Conditions





# Abner Clay Park – Prospective Park/Urban Design Schematic – Preliminary Layout

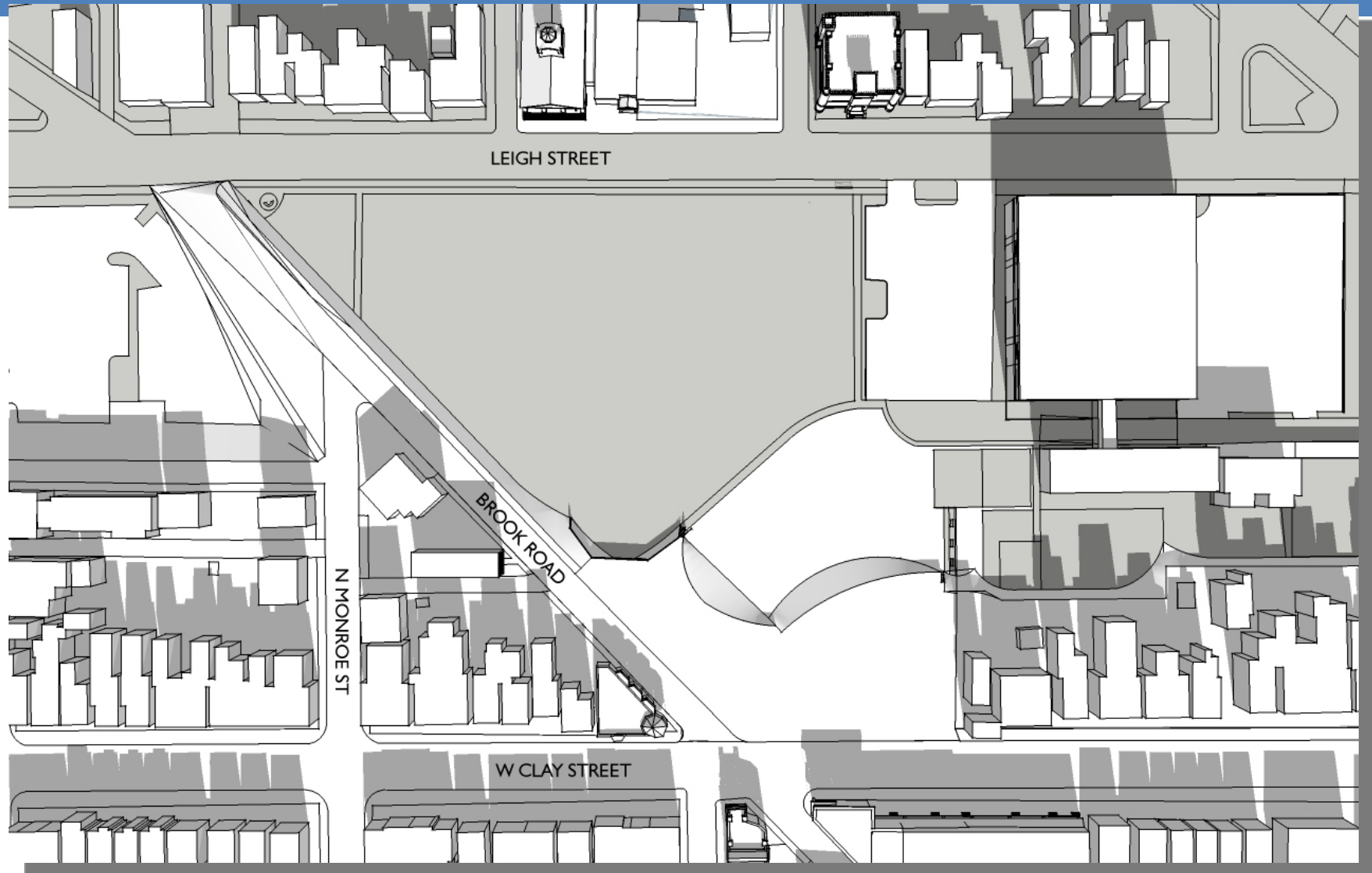

# Abner Clay Park – Prospective Park/Urban Design Schematic – Final Layout



# Goal of the park

- My goal for this park facility is to be able to bring diverse groupings of people to the area for relaxation, arts/entertainment & fun.
- Utilizing a Band Stage/Pavillion, Childrens' playground/splashpad, Dog Park and Farmers' Market, the space will focus on the enjoyment of the surroundings
- Using the current topography and sight lines, all aspects of the park can be seen from anywhere in the park or from entering at any of the major street intersections

# Abner Clay Park – Bird's Eye View from Leigh St





# Abner Clay Park – Bird's Eye View from Leigh St



# Abner Clay Park – Bird's Eye Views



All elements of park facility tied into each other by 3 factors:

- Family
- Fun
- Visibility





# Exercise Park\ Basketball Court

- Provides a focal point at main corner of park
- Enhances a sense of security with people working out in the park
- Enhances socialization factor

Includes exercise path as well as a half court basketball court

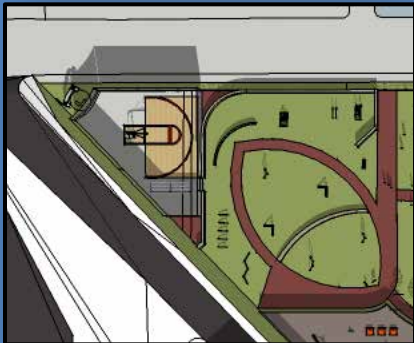

# Ruff Time – Dog Park

- Socialization of people and their animal companions
- Provides exercise outside of normal home environment
- Provides a safety factor for people enjoying the park area





# Bandshell Pavilion – Arts & Entertainment Complex

- Invites daily/weekly events to park area
- Gathering place for all walks of life
- Focus on arts & entertainment including bands, plays, art shows, etc

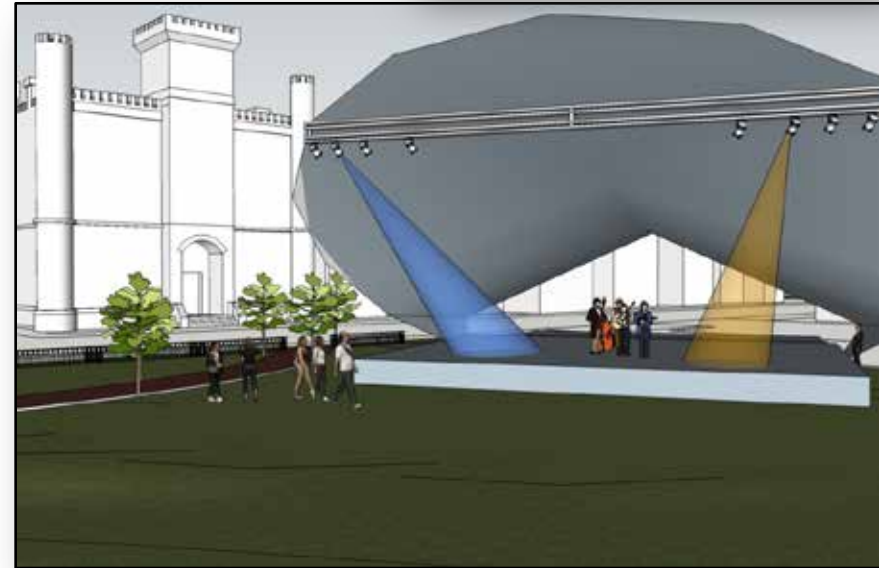
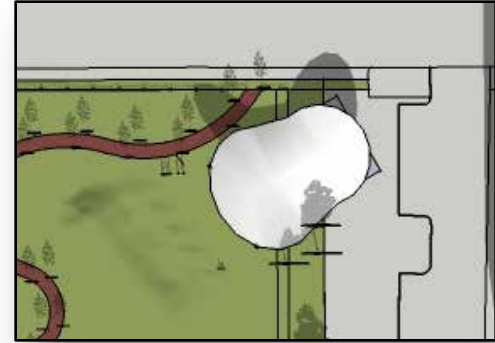

- Slight raised area with seating facing pavilion/band stage area

# "SPLASHDOWN" Splashpad & Children's' Playground

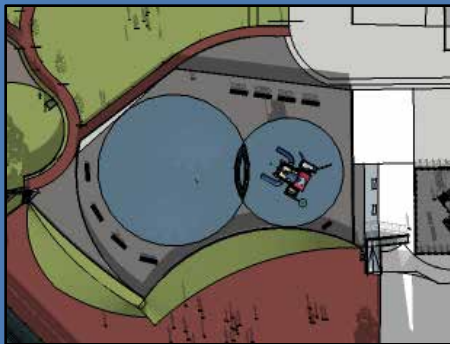
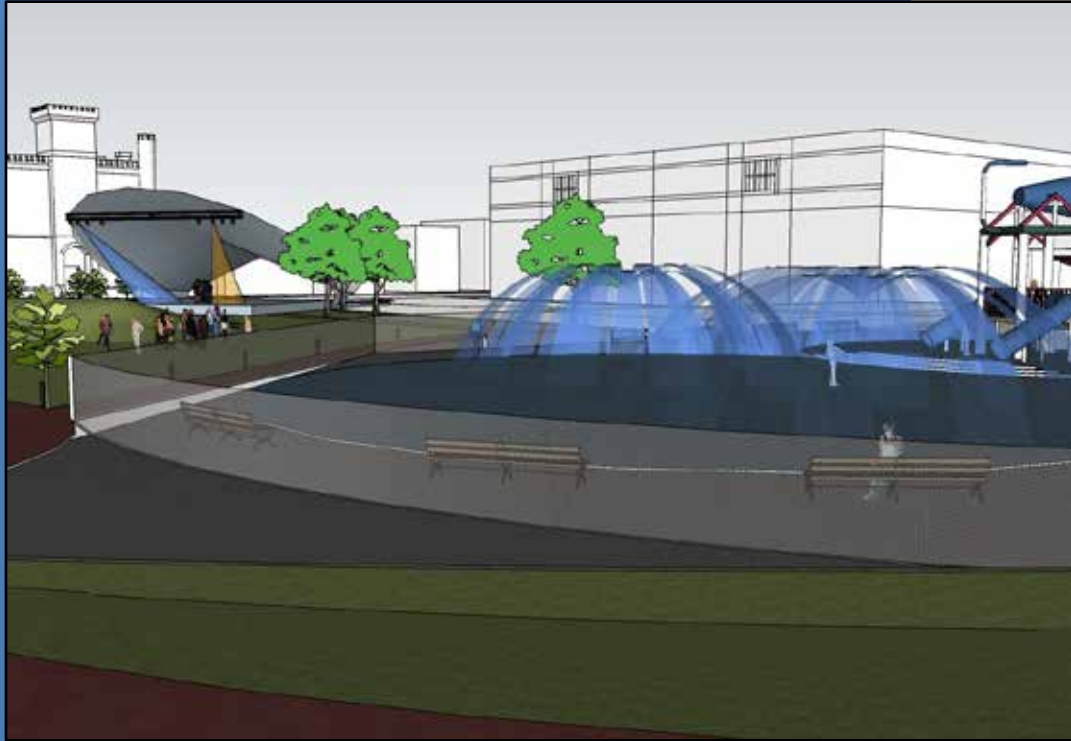

- Combination of kids, adults and dogs enhance a sense of security in the park
- Relates to the existing daycare facility
- Provides exercise for the kids in both warm and cool climates



# "SPLASHDOWN" Splashpad & Children's' Playground

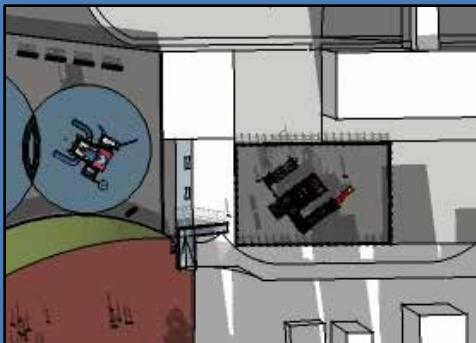
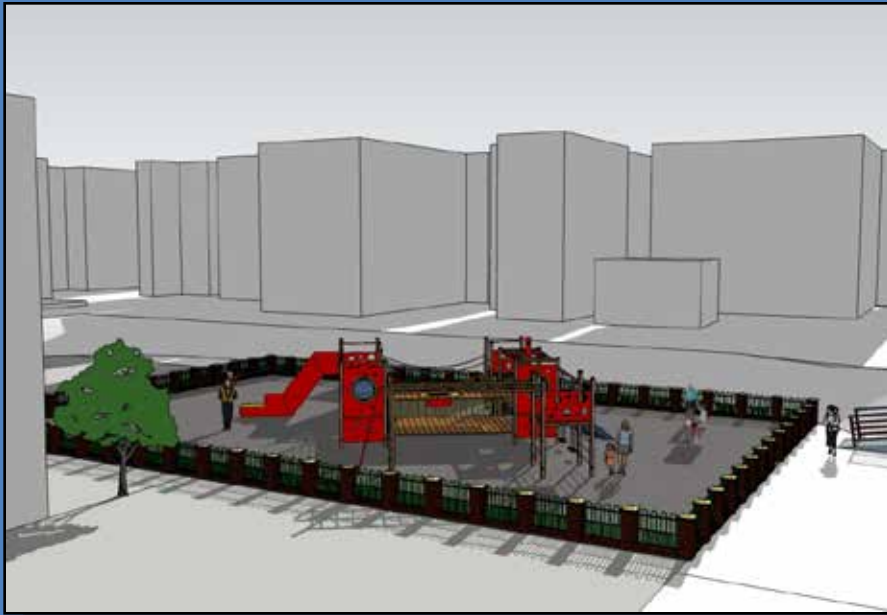

# Local Growers Farmers' Market

- Encourages local growers to share items
- Brings social groups together
- Can combine art market and farmers' market
- Can be seen from Broad Street as a focal element to the park

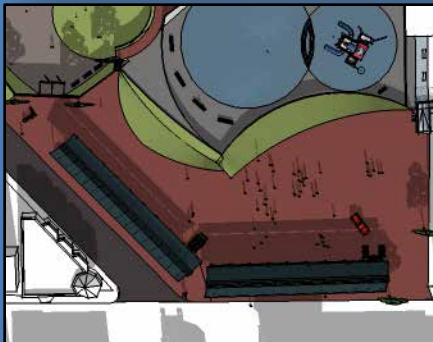



# Assignment 1 – Rectangular Space

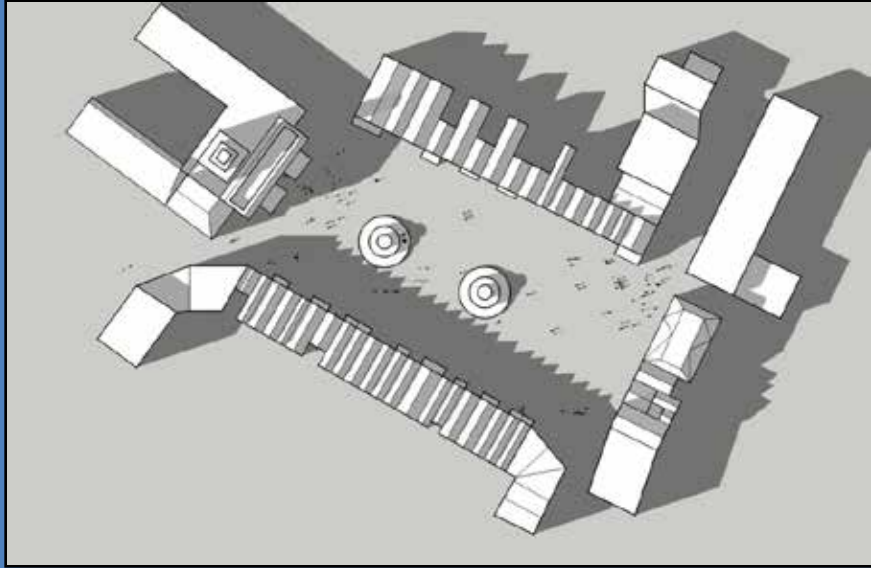

Plan View

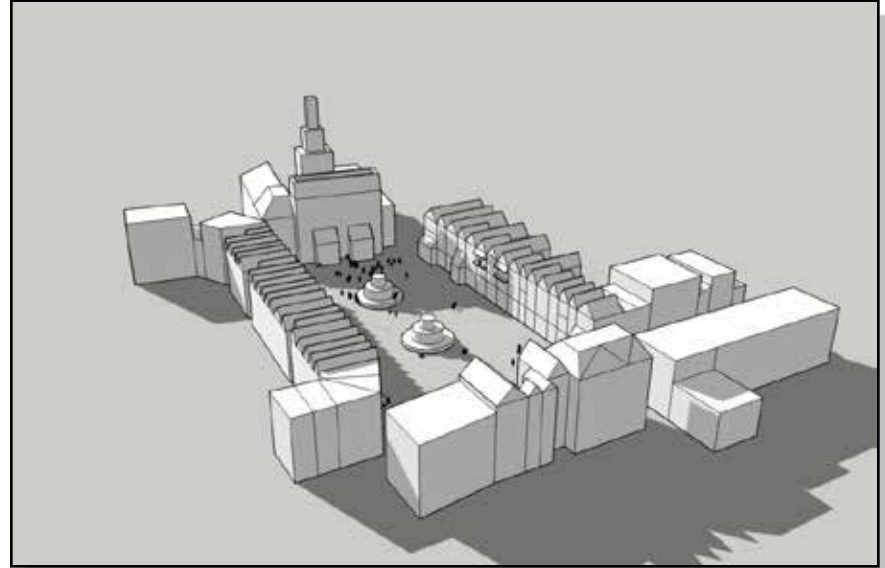

Bird's Eye View



Ground Level Perspective

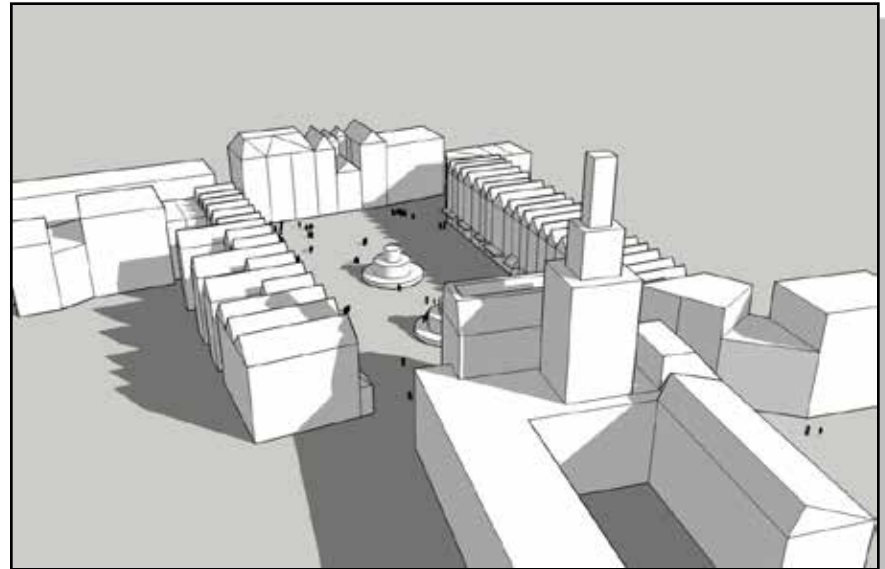

Bird's Eye View

# Assignment 1 – Circular & Square Spaces

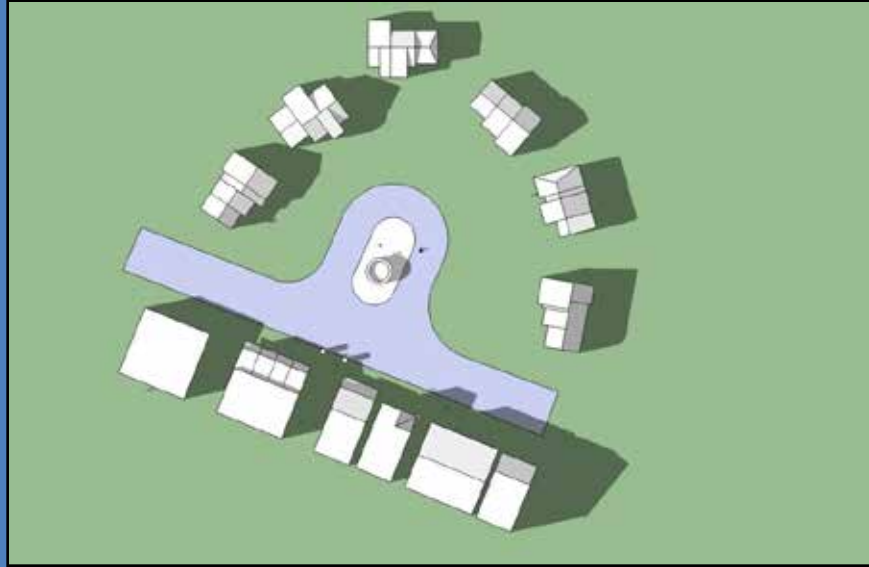

Plan View

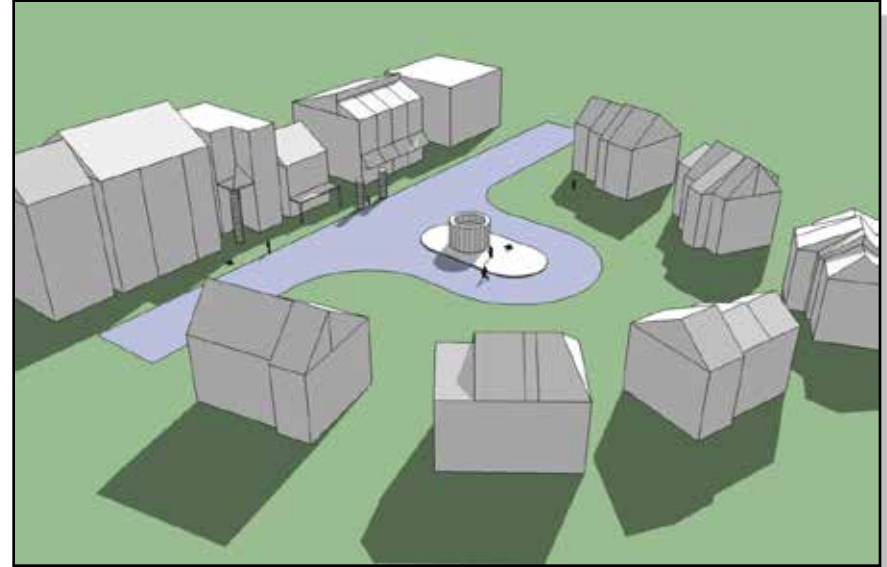

Bird's Eye View

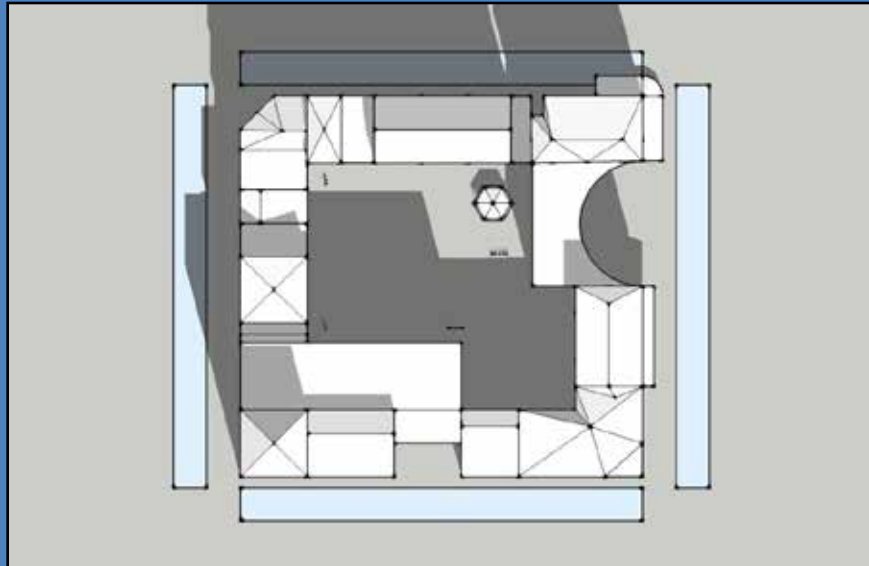

Plan View

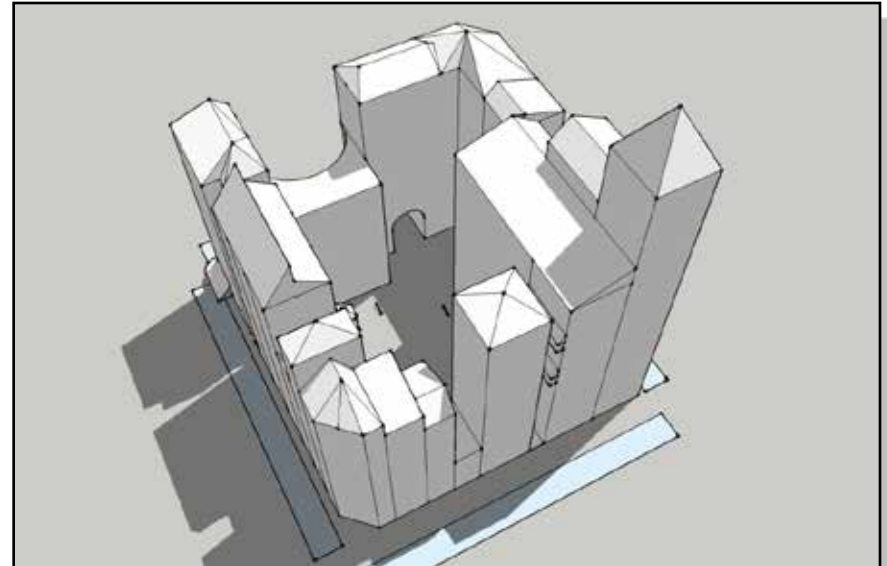

Bird's Eye View



# Saint Marks Square

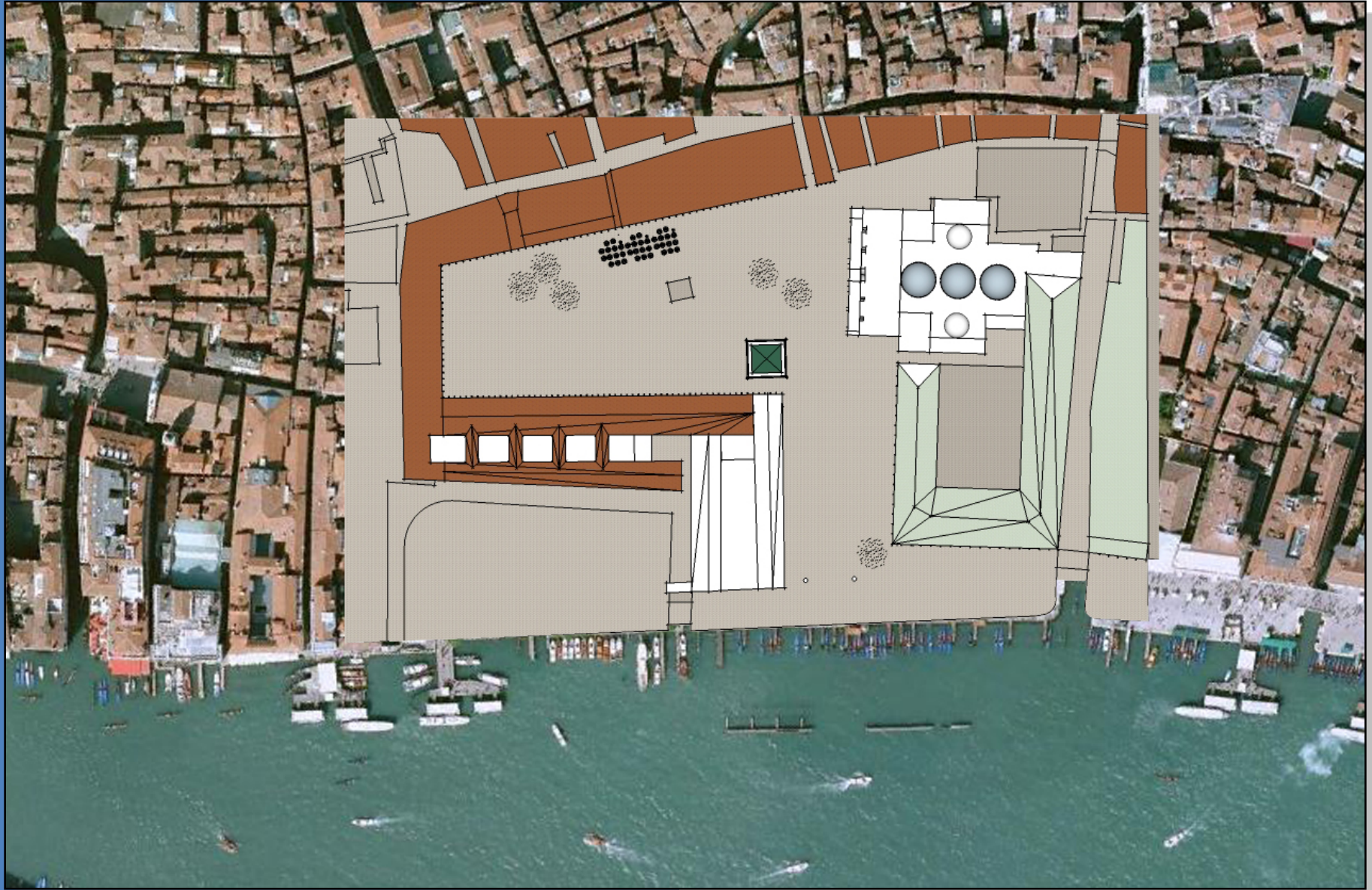



# Saint Marks Square



Plan view

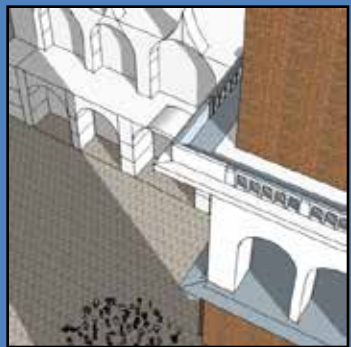
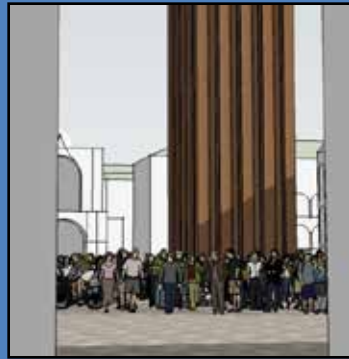
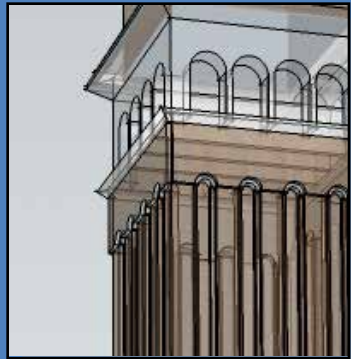



# Lombardy Park Group Model



# Lombardy Park Group Model

